



Remote Data Logging : on-line & real time

PRODUCT TYPE

Hygronet™

PRODUCT DETAILS

Internet enabled temperature, humidity & WME sensor system, with 4 remote sensing units, connecting to a base station reporting 20 data channels every 30 minutes via a dedicated web bureau service.

PRODUCT ILLUSTRATION

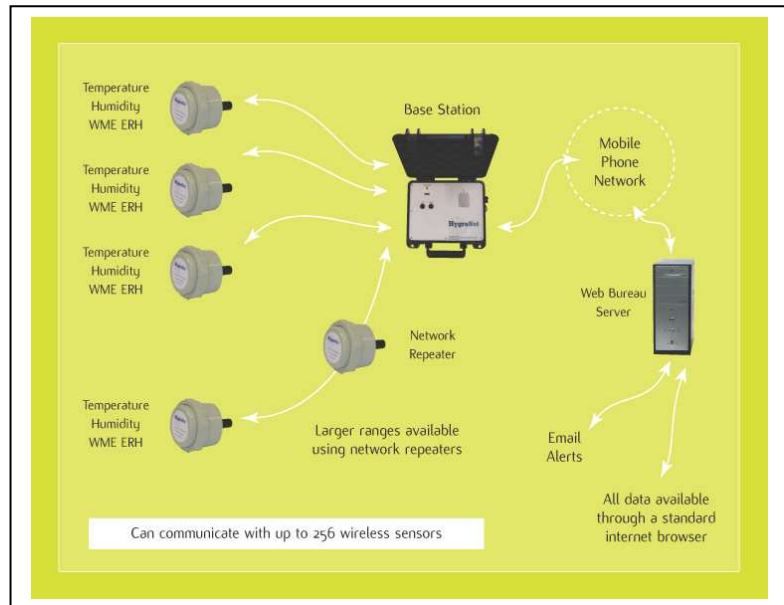

CLIENT

Vortex

LOCATION

UK

KEY BENEFITS

- ✓ Data from multiple locations accessible 24/7 to monitor drying, stabilisation, further drying..
- ✓ Eliminated time and cost of travel to inspect
- ✓ Identify failures in sheeting/tenting
- ✓ Audit trail available for insurer and end client

CLIENT STATEMENT

"We had to conduct the drying exercise very sensitively to ensure that we did not over-dry the original lime-based plaster and exposed structural timbers in the rest of the inhabited property. The HygroNet system helped us monitor the drying in real time and even identify when a rip in the poly tenting occurred which then enabled us to repair the sheeting within 24 hours thereby rapidly restoring the effectiveness of the drying system. The real time reporting also provides us with much more accurate sampling data than manually taking measurements from wall, or floor inserts and having to wait for them to equalise." Mr Simon Clarke, Vortex

ILLUSTRATIONS

Fig 1:- Trend of sensor that was placed under poly tent, this clearly shows when the tent ripped allowing a prompt visit to site to repair

